

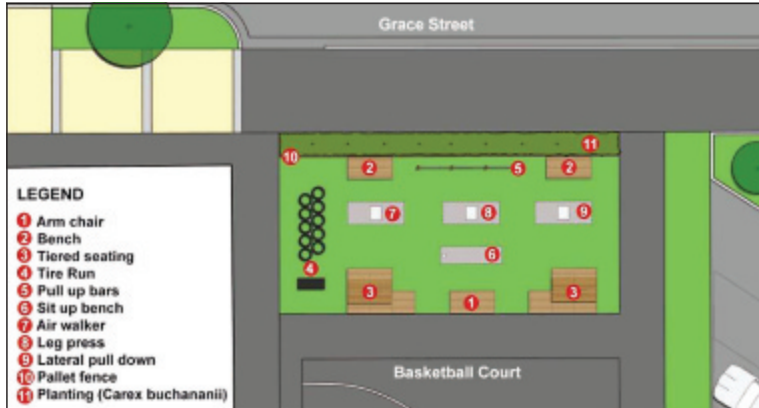

## Outdoor Gym - It's A Go!

Our outdoor gym in the South Alive Community Park is taking shape. Thanks to the Active Communities funding scheme, we have the money for the equipment and are now seeking funds for ground preparation and finishing. We hope to have it all working before Christmas.



Jamahl Lobb from Bin Inn driving our Hirepool digger to prepare the ground for the outdoor gym

## Dog Park Opening

Calling all dogs ... and their owners! The Dog Park will be officially opened on Sunday 24 November at 1.30pm. Everyone is welcome – whether or not you have a dog. We'll have activities, a sausage sizzle and plenty of people on hand to answer all your questions. We look forward to seeing you.

## Arts & Crafts Group Forming

Calling all artists, crafters, performers and people interested in the arts who are willing to organise arts projects. We'd love to have your help to make South Invercargill a great arts destination - whether it's street art on every corner, visual art on display, aerial art in the mall, music, drama or anything else you can think of. Come along to our first session - Thursday 21 Nov, 6.30pm South Alive office in the mall. Contact Janette 218 6688 for more info, or just show up.



## Housing Group Garden Competition

Let the planting begin! Our second garden competition is coming, and entries close on 7 February, 2014.

With seven categories, there is surely something for everyone. Try your hand at any or all of: Flower, Vegetable, Street Frontage, Best New Garden, Best Rental Garden, Best Owner/Occupier and Best School Garden.

We're very grateful to the companies and organisations that are once again providing such great prizes - Awarua Synergy, Diacks Nurseries, Glasines, ILT, Mighty Meats, Mitre 10, ICC Urban Rejuvenation Fund. Application forms are now available from the South Alive Office, Diacks Nurseries and South City Gifts & Lotto Shop.



## New Events Group

A new group has been formed that will focus on things to do in South Invercargill. Their first projects are to create trail maps - 15 unique, must visit places in South Invercargill; 15 heritage sites to visit in South Invercargill and 15 spots to visit on your bike.

They'd love more members, so if you're interested please contact Sheree tel: 218 9100 or come along to the next meeting (see What's On). They would also love to hear of any other events ideas.

## The Neighbourhood Projects FUND

Three successful projects were recently announced in the first round of our Neighbourhood Project Fund. They were Aperahama Church's community garden project, New River Primary's walkway behind the school and Oreti Street Neighbours Xmas street party.

The aim of the fund is to support new projects which will benefit your local neighbourhood in some way - make it more fun or beautiful or strengthen relationships by helping each other or learning new skills.

Applications will close for the second round of the fund on March 17, 2014. See us, or our website, for Information and Application forms.



Reverend Cannon Kevin Thompson (Aperahama Church); Elaine McCambridge (New River Primary); Gayle Hammond (Oreti Street); and front row, Kavarn Pettigrew (Year 6) and George Mara (Year 5).

## Fruit & Nut Tree Group, aka 'The Mulchers'

Our fantastic 'Fruit & Nuts' recently planted another 40 trees in public spaces around South Invercargill and they've now followed this up with mulching - a huge task, helped a lot by TNZ donating the mulch and McNeill Distribution delivering it - thanks guys!



In front of the mulch - Jacquie Webb, Diane Baker, Nathan Gill (McNeill Distribution) Trevor McKenzie, Leo Groszewski

## Donations sought for fund-raising hampers

South Alive needs to raise funds for our organisation and projects so we can continue to make a positive difference in South Invercargill - and we'd be very grateful for your help.

If you can donate any goods (or services) to include in our Christmas Hamper raffles please call Marie tel: 215 5690, or drop off your donations at our office, or the South City Gifts & Lotto Shop. All cash donations are tax deductible (ask us for a receipt).



## Thanks to our fantastic sponsors!

These businesses and organisations keep the south alive! So please support them wherever you can - and tell them you saw their name here.

**Department of Corrections** - for organising so much help via many working bees assisting South Alive projects

**Hirepool** - for again loaning us free hire equipment (see Digger photo).

**McNeill Distribution** - for organising delivery of the mulch and Nathan Gill for delivering it

**Preston Russell Law** - thanks to the persistence and hard work of James Cambridge at PR Law, we are finally a registered charity

**TNZ's Corey and Luke** - for donating 25 cub. metres of mulch for our fruit tree orchards.

## What's on this month...

**Dog Park Official Opening** - Sun 24 Nov, 1.30pm. Sausage sizzle & activities. All welcome

**Christmas Hamper raffle to raise funds for South Alive** - donations for the hamper gratefully accepted. Can be dropped at South Alive office, South City Gifts & Lotto, or call Marie on 216 5690 for collection

**Summer Splendour Garden Competition** - entries close 7 Feb 2014

**Choir** - meets every Thursday at 7.00pm at St Andrews Church, Elles Road. Gold coin donation. Tel Jo 214 2373 for more information or just show up. All welcome. No auditions.

**Action Group meetings this month** - new members/potential members welcome to attend. Contact South Alive office for more information or just show up. All welcome.

- **Events Group** - Wed 20 Nov, 5.15pm South Alive office
- **Arts & Crafts** - Thu 21 Nov, 6.30pm South Alive office
- **Fruit and Nut Trees** - Mon 25 Nov, 7pm 22 Nichol Street
- **Children & Youth Projects** - Tue 26 Nov, 6.30pm Aurora College Boardroom
- **Beautification** - Wed 27 Nov, 5.30pm South Alive office
- **Housing Group** - Thu 28 Nov, 6.00pm South Alive office

For more information on any of our events or meetings, contact us in any of the ways listed under our 'Contact details'.



## Contact details

• **Office:** Shop 6, South City Mall. PO Box 7055, Invercargill

• **Opening Hours:**  
Mon & Tue 11.30am - 1.30pm  
Wed 11.00am - 3.00pm  
Thu 3.30 - 5.30pm  
Fri 12.00 - 2.00pm  
Sat 10.30am - 12.30pm

• **Email:** southalive@gmail.com

• **Telephone:** 218 6882

• **Or:** Registration /idea forms at our yellow letterbox, in South City Gifts & Post Shop. 'Post' your forms in the letterbox, and we'll contact you